

GMDSF Sway Foot Levelling Glide

Features

- Suitable for server racks, precision instruments, medical equipment, cabinets and furniture, etc.
- Base isolation structure absorbs vibrations and shocks
- Reduces installation cost
- Reduces the risk of falling furniture or equipment
- Can be used on raised floor
- Applied to server systems of major manufacturers
- Sold in set of 4 pcs

Notes

- Use on a level floor
- When installing the bolt to a cabinet, ensure that it is perpendicular to the base
- Do not touch the sliding surface as it is coated with lubricant



Parts Structure (for 1 piece)



Comparison Against Standard Levelling Glides

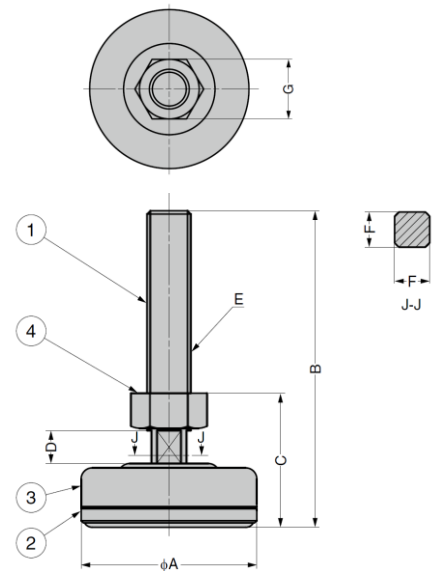
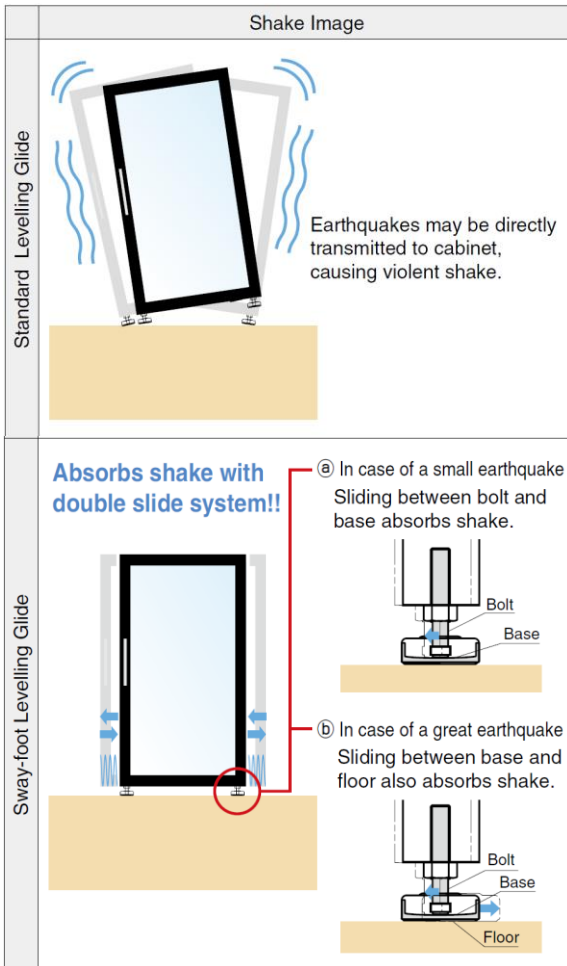

No.	Part Name	Material	Finish
①	Threaded Bolt	Steel	Nickel
②	Base	Steel/Teflon	
③	Cover	Nitrile Rubber (NBR)	—
④	Hex Nut	Steel	Clear Zinc Chromate (Trivalent)

Sold as a set (4 pcs)

Part No.	A	B	C	D	E	F	G	Max. Size	Load Capacity (per 4 pieces)	
GMDSF58-10-40	58	65.5	34.5	7.5	M10	8	17	W410 × D630 × H390	2,000 N	204 kg
GMDSF58-16-80		114	48	10.5	M16	13	24	W730 × D730 × H1460	5,000 N	510 kg
GMDSF80-20-100	80		61	15	M20	16	30	W1000 × D1000 × H2000	7,500 N	765 kg